

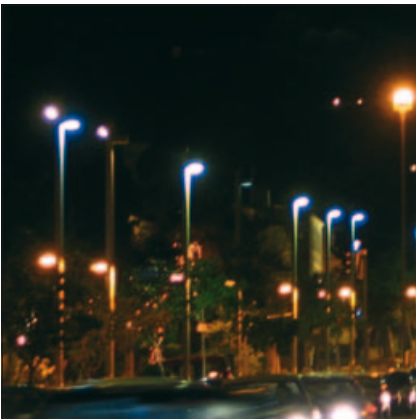

A New Lighting Experience



## **Constant Wattage Autotransformers**

**For ANSI Type Discharge Lamps**

**Vossloh-Schwabe Deutschland GmbH**

P.O. Box 2869 · 58478 Lüdenscheid · Germany

Phone (+49-23 51) 101-0 · Fax (+49-23 51) 101-217/-384

**[www.vossloh-schwabe.com](http://www.vossloh-schwabe.com)**

# Constant Wattage Autotransformers

## For ANSI Type Metal Halide Lamps

Shape: 108x106 mm

Vacuum impregnated with polyester resin

Screw terminals: 1.5–4 mm<sup>2</sup>

### Protection class I

tw 130

Acc. to EN 61347/60923

Capacitor included

The Capacitor is essential for circuit operation

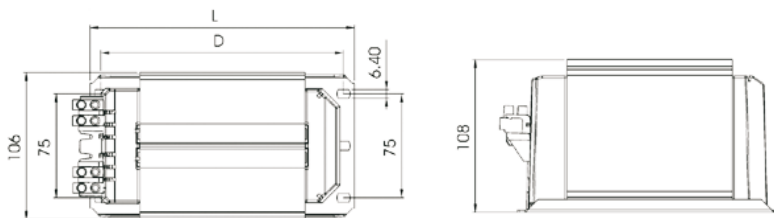
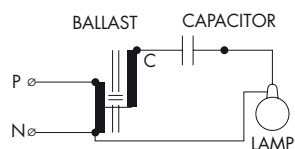

MH Lamp			Ballast							Capacitor		Line	
Type ANSI CODE	Rated Power W	Rated Current A	Type	Ref No.	V, Hz	Power Losses W	$\Delta t$ $^{\circ}C$	Weight kg	Dimensions L mm D mm		$\mu F \pm 2.5\%/V$	Current A	Power Factor
M58	250	2.15	JCWA 250.004	<b>532470</b>	220, 50	40	70	5.3	152	137	18/450	1.35	0.98
M58	250	2.15	MCWA 250.005	<b>532471</b>	230, 50	40	70	5.3	152	137	18/450	1.26	0.99
M59	400	3.25	MCWA 400.011	<b>532472</b>	110, 60	55	75	6.8	152	137	24/450	2.20	0.99
M59	400	3.25	JCWA 400.004	<b>532473</b>	220, 50	48	75	6.8	152	137	30/450	2.10	0.99
M59	400	3.25	MCWA 400.008	<b>532474</b>	220, 60	55	75	6.8	152	137	24/450	2.20	0.99
M59	400	3.25	MCWA 400.005	<b>532475</b>	230, 50	55	70	6.8	152	137	30/450	1.90	0.99
M59	400	3.25	MCWA 400.006	<b>532476</b>	240, 50	55	75	6.8	152	137	30/450	2.10	0.99
M47	1000	4.10	JCWA 1000.004	<b>532477</b>	220, 50	60	70	10.5	192	173	34/500	4.80	0.98
M47	1000	4.10	MCWA 1000.012	<b>532478</b>	220/230/240, 50	65	70	10.5	192	173	34/450	4.70	0.99
M47	1000	4.10	MCWA 1000.005	<b>532479</b>	230, 50	60	70	10.5	192	173	34/450	4.70	0.99
M47	1000	4.10	MCWA 1000.006	<b>532480</b>	240, 50	60	70	10.5	192	173	34/450	4.50	0.99

# Constant Wattage Autotransformers with Lead Wires

**For ANSI Type Metal Halide Lamps For the North American Market**

- Cross section: 4.25"x4.17"
- Vacuum-pressure impregnated core and coil
- Low noise
- Closed end caps
- Compatible mounting hole spacing
- All holes cleared for # 10 thru-bolts
- Power factor:  $\geq 0.95$
- Acc. to EN 61347/60923
- Capacitor included
- Class H insulation system (180°)
- The Capacitor is essential for circuit operation

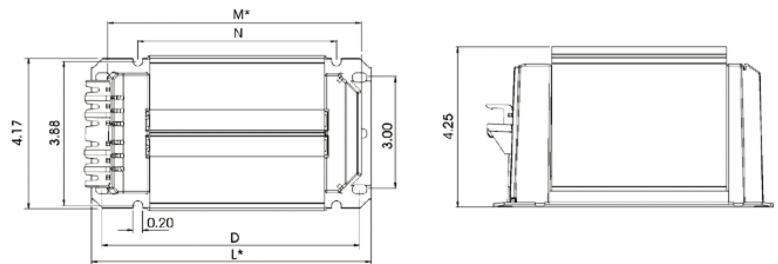
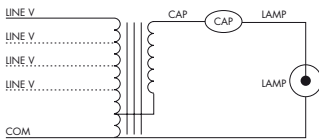

MH Lamp			Ballast 120/208/240/277 V – 60 Hz*							Capacitor	Line	UL	
Type	Rated Power	Rated Current	Type	Ref. No.	Weight	Dimensions				$\mu\text{F} \pm 2.5\% / \text{V}$	Power	Current	Benchtop
ANSI CODE	W	A			lbs.	L	D	N	M		W	120/208/240/277 V	Temp. Rise Code
M57	175	1.5	MCWA 175.710	<b>532466</b>	7.9	5.98	5.38	3.50	3.98	10/450	200	1.73/1.00/0.86/0.75	A/A/A/A
M58	250	2.15	MCWA 250.711	<b>532467</b>	11.0	5.98	5.38	3.50	4.57	15/450	288	2.50/1.45/1.25/1.10	A/A/A/A
M59	400	3.25	MCWA 400.701	<b>532313</b>	15.6	5.98	5.38	4.38	5.36	24/450	450	3.84/2.22/1.92/1.67	B/B/B/B
M47	1000	4.10	MCWA 1000.712	<b>532468</b>	23.8	7.71	6.81	5.37	7.13	26/450	1060	9.10/5.20/4.50/3.90	A/A/A/A
M48	1500	6.20	MCWA 1500.713	<b>532469</b>	27.6	8.50	7.72	5.94	7.72	38/500	1585	13.60/8.00/6.90/6.00	C/C/C/C

\* Other voltages and frequencies available.

L\* Maximum overall length using standard Flexi-Mount base plate. Reduced Size (RS) base plate is available on request. See dimension M.

M\* Minimum ballast length dimension using RS base plate. Specify RS base plate when ordering.

# Constant Wattage Autotransformers with Lead Wires

For ANSI Type Pulse Start Metal Halide Lamps

For the North American Market

- Cross section: 4.25"x4.17"
- Vacuum-pressure impregnated core and coil
- Low noise
- Closed end caps
- Compatible mounting hole spacing
- All holes cleared for # 10 thru-bolts
- Power factor:  $\geq 0.95$
- Acc. to EN 61347/60923
- Capacitor included
- Class H insulation system (180°)
- The capacitor and ignitor are essential for circuit operation

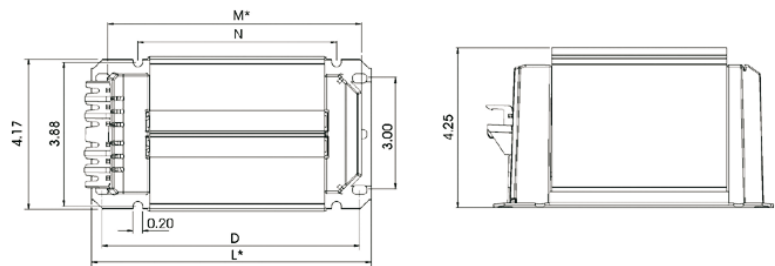
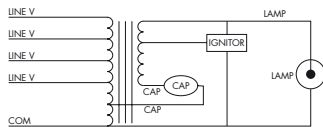

MH Lamp			Ballast 120/208/240/277 V – 60 Hz*							Capacitor	Line		UL Benchtop Temp. Rise Code	Ignitor
Type ANSI CODE	Rated Power W	Rated Current A	Type	Ref. No.	Weight lbs.	Dimensions				$\mu\text{F} \pm 2.5\%/V$	Power W	Current 120/208/240/277 V		
						L inch	D inch	N inch	M inch					
M136	200	1.60	PCWA 200.705	<b>532461</b>	7.9	5.98	5.38	3.50	3.98	16/300	230	1.95/1.13/0.98/0.85	A/A/A/A	ESCWA 400
M138/153	250	2.10	PCWA 250.706	<b>532462</b>	11.0	5.98	5.38	3.50	4.57	15/450	290	2.45/1.41/1.22/1.06	A/A/A/A	ESCWA 400
M132/154	320	2.65	PCWA 320.707	<b>532463</b>	11.0	5.98	5.38	3.50	4.57	22/350	360	3.10/1.80/3.10/1.80	B/A/A/A	ESCWA 400
M131	350	2.80	PCWA 350.708	<b>532464</b>	11.0	5.98	5.38	3.50	4.57	24/450	395	3.35/1.95/1.70/1.45	B/B/B/B	ESCWA 400
M128/135/155	400	3.25	PCWA 400.709	<b>532465</b>	15.6	5.98	5.38	4.38	5.36	24/450	450	3.85/2.20/1.90/1.65	B/B/A/A	ESCWA 400

\* Other voltages and frequencies available.

L\* Maximum overall length using standard Flexi-Mount base plate. Reduced Size (RS) base plate is available on request. See dimension M.

M\* Minimum ballast length dimension using RS base plate. Specify RS base plate when ordering.

# Constant Wattage Autotransformers

**For ANSI Type HPS Lamps Type A S52 1000W**

Shape: 108x106 mm  
 Vacuum impregnated with polyester resin  
 Screw terminals: 1.5-4 mm<sup>2</sup>

**Protection class I**

tw 130  
 Acc. to EN 61347/60923  
 Capacitor and ignitor included  
 The capacitor and ignitor are essential for circuit operation

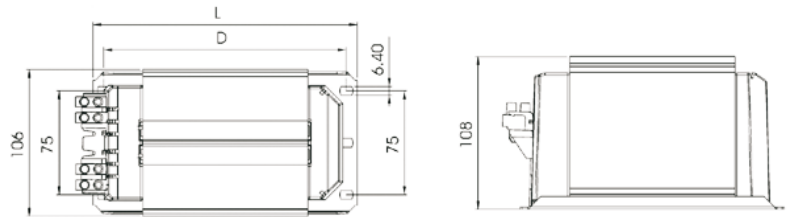
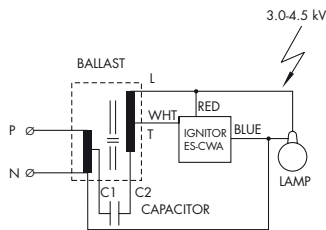

HPS Lamp			Ballast								Capacitor	Line		Ignitor
Type ANSI CODE	Rated Power W	Rated Current A	Type	Ref. No.	V, Hz	Power Losses W	Δt °C	Weight kg	Dimensions L mm D mm		μF±2.5%/V	Current A	Power Factor	
S52	1000	4.70	SCWA 1000.004	<b>532458</b>	220, 50	95	80	12.5	216	196	36/450	5.60	0.99	ES-CWA 1000
S52	1000	4.70	SCWA 1000.005	<b>532459</b>	230, 50	95	80	12.5	216	196	36/540	5.41	0.99	ES-CWA 1000
S52	1000	4.70	SCWA 1000.006	<b>532460</b>	240, 50	95	80	12.5	216	196	36/540	5.20	0.99	ES-CWA 1000

\* Other voltages and frequencies available

# Constant Wattage Autotransformers with Lead Wires

## For ANSI Type HPS Lamps For the North American Market

- Cross section: 4.25"x4.17"
- Vacuum-pressure impregnated core and coil
- Low noise
- Closed end caps
- Compatible mounting hole spacing
- All holes cleared for # 10 thru-bolts
- Power factor:  $\geq 0.95$
- Acc. to EN 61347/60923
- Capacitor included
- Class H insulation system (180°)
- The capacitor and ignitor are essential for circuit operation

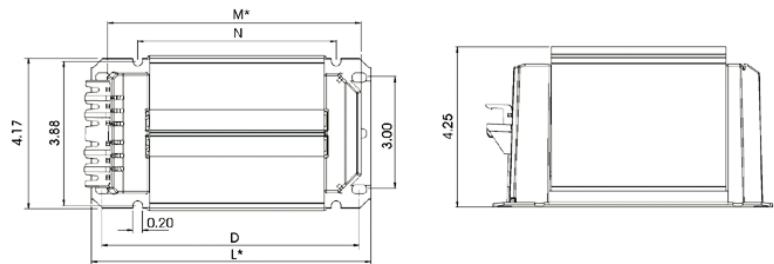
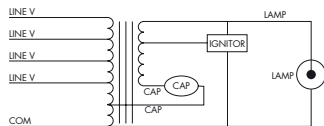

HPS Lamp			Ballast 120/208/240/277 V – 60 Hz*							Capacitor	Line		UL	Ignitor
Type ANSI CODE	Rated Power W	Rated Current A	Type	Ref. No.	Weight lbs.	Dimensions				$\mu\text{F} \pm 2.5\% / \text{V}$	Power W	Current 120/208/ 240/277 V	Benchtop Temp. Rise Code	
						L inch	D inch	N inch	M inch					
S50	250	3.0	SCWA 250.702	<b>532454</b>	11.0	5.98	5.38	3.50	4.57	35/300	295	2.60/1.50/ 1.30/1.15	C/A/A/A	ES-CWA 400
S51	400	4.6	SCWA 400.703	<b>532456</b>	15.6	5.98	5.38	4.38	5.36	55/300	450	4.00/2.30/ 2.00/1.70	D/C/C/C	ES-CWA 400
S106	600	6.2	SCWA 600.704	<b>532457</b>	23.8	7.71	6.81	5.37	7.13	72/300	665	6.00/3.50/ 3.00/2.60	C/A/A/A	ES-CWA 400
S52	1000	4.7	SCWA 1000.700	<b>532312</b>	27.6	8.50	7.72	5.94	7.72	30/500	1090	9.50/5.40/ 4.70/4.10	E/D/D/D	ES-CWA 1000

\* Other voltages and frequencies available

L\* Maximum overall length using standard Flexi-Mount base plate. Reduced Size (RS) base plate is available on request. See dimension M.

M\* Minimum ballast length dimension using RS base plate. Specify RS base plate when ordering.